

## Stop Restraint - Debris Guard Retrofit

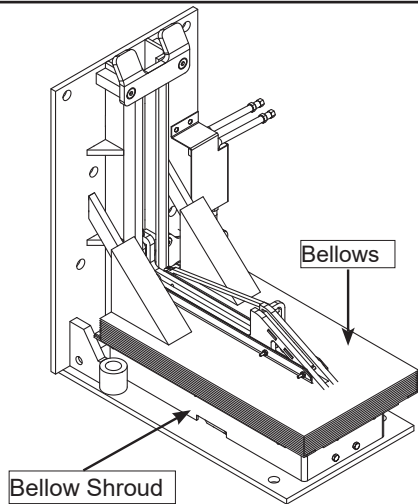

Fig. 1

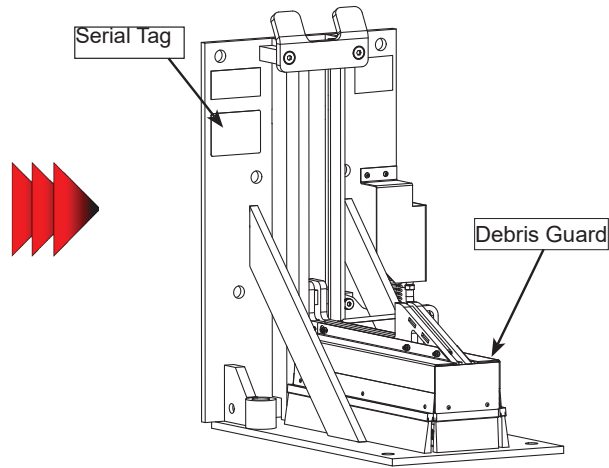

Fig. 2

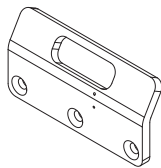

Fig. 3

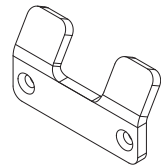

Fig. 4

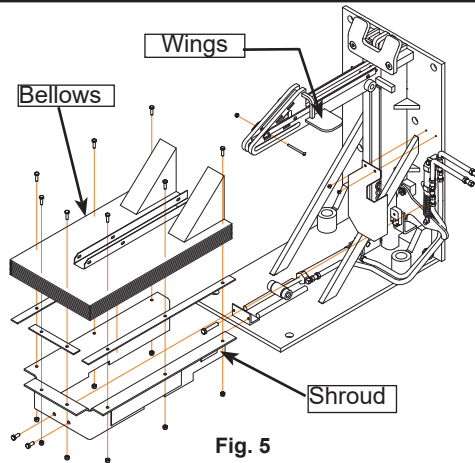

Fig. 5

### 9416-0006 - Kit Contents

9412-0289	1/4", Split Flex Conduit, 35" Long	1
3051-0001	Cable Tie	3
2101-0377	Screw, THMS, Torx, #10-24x2	3
2101-0151	Nut, Nylon, Lock, 10-24, UNC	3
0195-0052	Stop, Debris Guard Assembly	1
1751-xxxx	Brand Decal	1
1751-0735	Made In U.S.A. Decal	1
1751-1290	Serial Decal	1

Stop-style restraints from Poweramp, DLM and McGuire are now equipped with a debris guard, (Fig. 2) instead of pleated bellows, (Fig. 1). Stop restraints from early 2018-forward, are compatible with the debris guard. Use the lip deflector as an indication of compatibility, if manufacture date is unknown.

- Restraints that have a lip deflector with three holes (Fig. 3), will continue to use a bellow assembly.
- Restraints that have a lip deflector with only two holes (Fig. 4), will use the new debris guard assembly.

### Retrofit Kit Installation Instructions

1. Raise the restraint and lock-out/ tag-out the equipment. Barricade the work area at dock and ground level.
2. Remove the existing bellow and shroud assemblies, (Fig. 5). When removing the screws and lock nuts that attach the bellows to the hook, remove the front two first, (Fig. 6).
3. The rear screw holds a spring for the rig sensor bar. Remove the lock nut from the rear screw, then pull the spring with a hook. (Not included, Fig. 8). While holding the spring, remove the screw and move the mounting bars and bellows out of the way. Then insert the new screw (2101-0377) and reconnect the spring to it,

*Installation Instructions continued on page 2.*

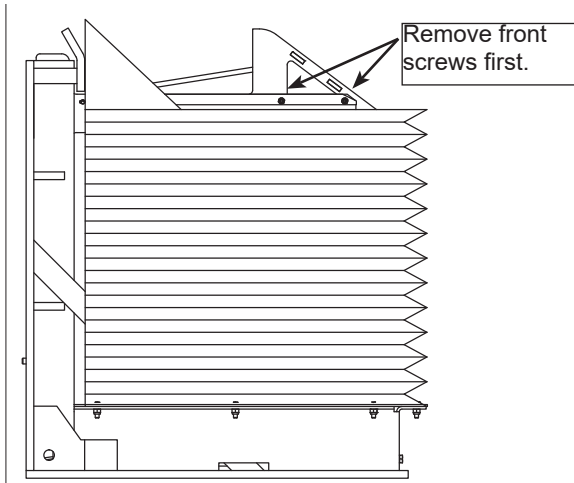

Fig. 6



Fig. 7



Fig. 8

(Fig. 7). Partially install the locknut, do not tighten it fully at this time.

4. With the hook weldment exposed, remove the “wings” using a cut-off wheel, (Fig. 5).
5. Remove the cable ties securing the hook sensor wire to the scissor assembly, (Fig. 9). Then install the corrugated split flex conduit on the sensor wire and secure it to the scissor assembly tag hole washers, using the included cable ties.
6. Position the debris guard assembly over the hook, by sliding the keyhole slots over the rear screw, (Fig. 10). With the debris guard keyhole slots over the rear screw, push the debris guard backward to seat the screw in the slot. With the screw in the key slots, tighten the lock nut to secure the debris guard.
7. Secure the front two lock nuts and screws and verify the sensor cable will not interfere with any components. Then test the restraint for correct operation.
8. Apply the decals included with the kit, (See Figures 2 and 10).

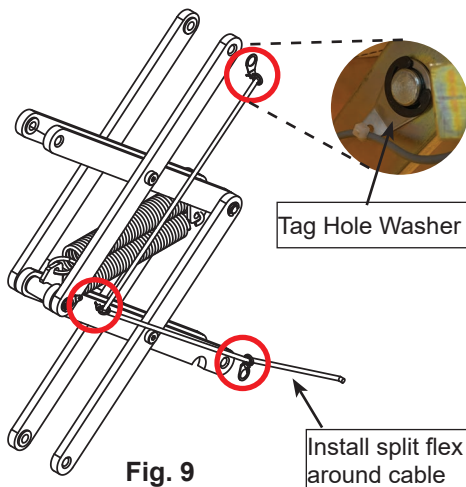

Fig. 9

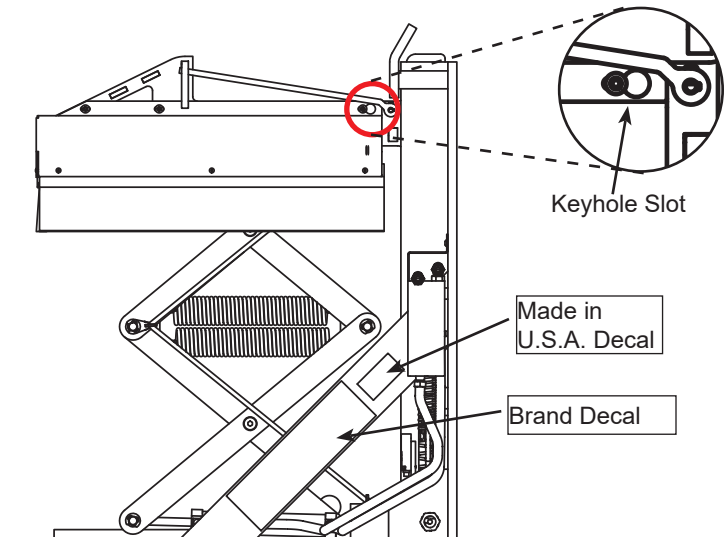

Fig. 10